

## DECK PLANS

# ABOARD WIND SURF



## ONBOARD SPACES

- |                         |                                       |                             |
|-------------------------|---------------------------------------|-----------------------------|
| 1 Bridge                | 8 Staterooms                          | 14 Nautilus Room            |
| 2 Stella Bistro         | 9 Lounge                              | 15 WindSpa                  |
| 3 AmphorA Restaurant    | 10 Yacht Club Sandwich & Espresso Bar | 16 Signature Shop           |
| 4 Bridge Suites         | 11 Fitness Center                     | 17 Pool/Pool Bar/Whirlpools |
| 5 Casino                | 12 Compass Rose Bar                   | 18 Watersports Platform     |
| 6 Veranda               | 13 Reception                          | 19 Terrace Bar              |
| 7 Suites and Staterooms |                                       | 20 Candles                  |

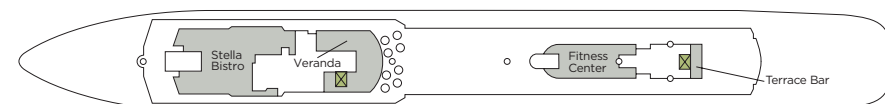

STAR DECK

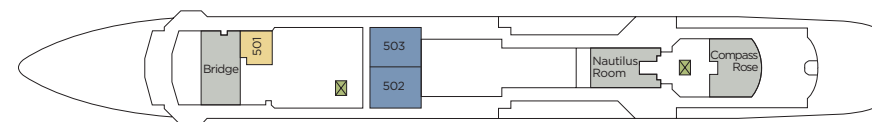

BRIDGE DECK

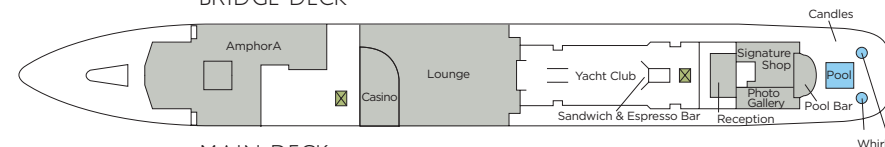

MAIN DECK

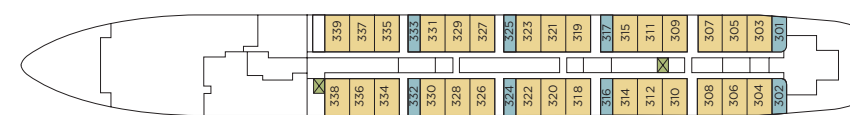

DECK THREE

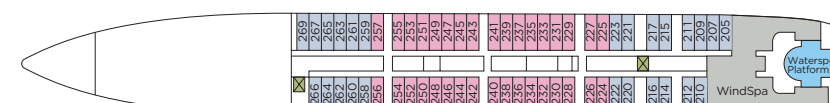

DECK TWO

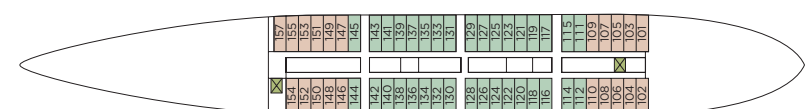

DECK ONE

## STATEROOMS & SUITES

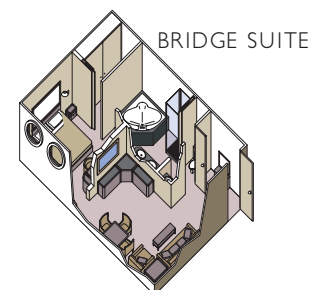

**Bridge Suites:** 495 square feet (46 square meters)

**Suite 501:** 376 square feet (35 square meters)

**Suites:** 376 square feet (35 square meters)

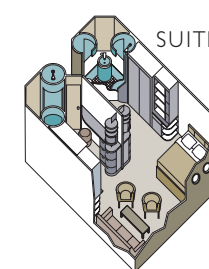

**Staterooms:** 188 square feet (18 square meters)

**Staterooms with 3<sup>rd</sup> Berths:** 117-139; all suites (excluding 501)

**Rooms with queen beds that convert into (2) twin beds:** 103-155; 205-269; 305-339; 501, 502, 503

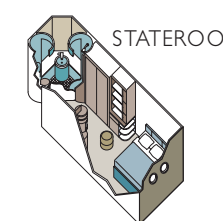

- BRIDGE SUITES
- SUITES
- CATEGORY TX DELUXE
- CATEGORY AX DELUXE
- CATEGORY A
- CATEGORY BX DELUXE
- CATEGORY B
- PUBLIC SPACES
- STAIRS/ELEVATOR

• Access to board ship is via stairs only.

• Access to/from outside deck may require assistance with doors and thresholds.

## SHIP FACTS

**GUEST CAPACITY:** 310

**GUEST DECKS:** 6

**CREW MEMBERS:** 191

**LENGTH:** 535 feet (162 meters) at waterline; 617 feet (187 meters) including bowsprit

**DRAFT:** 16.5 feet (5 meters)

**TONNAGE:** 14,745 gross registered tons (grt)

**BEAM:** 66 feet (20 meters)

**SAILS:** 7 triangular, self-furling, bridge-operated sails with 26,881 square feet (or 2,600 square meters) of Dacron surface area

**MASTS:** 5 at 164 feet (50 meters)

**ENGINES:** 4 diesel electric generator sets, 2 electrical propulsion motors

**SPEED:** 10 to 12 knots with engines only; up to 15 knots with prevailing wind

**SHIP'S REGISTRY:** Bahamas